



# Roofing excellence since 1979

3830 NW 16th Street  
Topeka, KS 66618  
Phone: (785) 232-4276  
Fax: (785) 232-2856  
Cell: 785-207-9834

Friday, January 13, 2023

adamh@midwestcoating.us  
<https://www.midwestcoating.us>

**Work to be performed for:**

**Carbondale Attendance Center  
315 North 4th Street  
Carbondale, KS 66414**

0

We hereby propose to furnish the materials and perform the labor necessary for the completion of a white 60 mil Mule-Hide TPO roof system to be installed at 315 North 4th Street Carbondale, KS. The roof is approximately 4225 sqft and will require approximately 791 sqft of parapet. The work will include the following:

- \* Prepare jobsite and surrounding area for installation of the white 60 mil Mule-Hide TPO roof system.
- \* Remove and dispose of gravel on roof area.
- \* Remove and dispose of the existing membrane only.
- \* Install 1/2"x4'x8' DensDeck over the roof area above the insulation.
- \* Install new mechanically fastened 60 mil Mule-Hide TPO as specified by the manufacturer.
- \* Install roofing membrane up and / or over parapet walls with edge detail as shown on CAD.
- \* Custom made and / or prefabricated flashings will be installed over all roof penetrations.
- \* Install new 24 ga steel metal canted coping with a continuous mounting cleat color is TBD.
- \* Install new .027" aluminum metal 5" seamless gutter and 3"x4" downspout(s) color is TBD.
- \* Install new 24 ga steel metal 5" - 1pc reglet color is TBD.

Please add the foot print of roof 4225 sqft plus parapet of 791 sqft for a total of 5016 sqft. Please see CAD drawing which shows both roofs are included.

**A 20 year standard warranty, furnished by Mule-Hide is provided.**

All material is guaranteed to be as specified, and the above work to be performed in accordance with the drawings and specifications submitted for above work and completed in a substantial workmanlike manner for the sum of:

**Due to current roofing industry wide conditions that are beyond our control, Midwest Coating, Inc. can not guarantee the material pricing as proposed for the duration of this contract. Material price increases incurred may be passed on to the customer.**

Pre-tax total:	\$35,125.00
Tax:	\$0.00
<b>Total:</b>	<b>\$35,125.00</b>



The parties acknowledge that some of the materials and products to be used and installed in the construction of this project may become unavailable, delayed in shipment and/or subject to price increases due to circumstances beyond the control of Midwest Coating, Inc.. If a specified product is unavailable or shipment is delayed, Midwest Coating, Inc. shall provide written notice and shall be afforded additional time and substitute products may be considered. If there is an increase in price of materials, equipment or products between the date of the agreement and the time when the project is ready for the installation of the affected material, the Contract Sum shall be increased to reflect the additional cost to obtain the materials, provided that Midwest Coating, Inc. provides written notice and documentation of the increased costs.

**Carbondale Attendance Center 0**

**Total including tax**

**\$35,125.00**

**Subject to the clause above.**

**General Conditions:** Owner is responsible for calibrating satellite receiver or antenna after roof is completed. Given that the deck integrity cannot be completely observed beneath the existing roof, if any rotten or deteriorated decking is discovered during the roofing process the owner will be notified ASAP and a replacement or overlay price will be negotiated at that time. Midwest Coating, Inc. does not guarantee ponding water will be completely eliminated when using a tapered insulation system.

**Payments to be made as follows:**

50% down payment due upon signing of contract.

Balance due upon completion of job.

A finance charge of 1.5% per month (18% per annum) will be charged to past due accounts.

Any alteration or deviation from above specifications involving extra costs, will be executed only upon written orders, and will become an extra charge over and above the estimate. Because abnormal moisture conditions of the roof resulting from previous moisture migration have been observed, it is agreed Midwest Coating, Inc. shall not be liable for deterioration or leaking of the roof, building damage or for personal injury which may result from such pre-existing condition. All agreements contingent on strikes, accidents or delays are beyond our control. Owner shall purchase and maintain builders risk or other property and liability insurance to protect his own investment. Midwest Coating, Inc. shall purchase and maintain such commercial General Liability, Workers Compensation and other insurance as is appropriate for the project, whether it is to be performed or furnished by Midwest Coating, Inc., by any direct sub-contractor, or by anyone directly or indirectly employed by Midwest Coating, Inc.

Proposal prepared by: **Adam Hoffman, 785-207-9834, adamh@midwestcoating.us**

Respectfully submitted by:

Note: This proposal may be withdrawn by us if not accepted within 15 days.

Randy D. Morris - President  
Midwest Coating, Inc.

Date: Friday, January 13, 2023

**ACCEPTANCE OF PROPOSAL**

The above prices, specifications and conditions are satisfactory and are hereby accepted. You are authorized to do the work as specified. Payment will be made as outlined above.

Date:

Signature:

**Due to current roofing industry wide conditions that are beyond our control, Midwest Coating, Inc. can not guarantee the material pricing as proposed for the duration of this contract. Material price increases incurred may be passed on to the customer.**

Building Height - 10'  
 Deck - Metal  
 Core - 5" to 12" (Large rock, EPDM, EPS)

Lower - 3,919 sqft  
 Upper - 306 sqft  
 Total - 4,225 sqft



Total Parapet 791 sqft

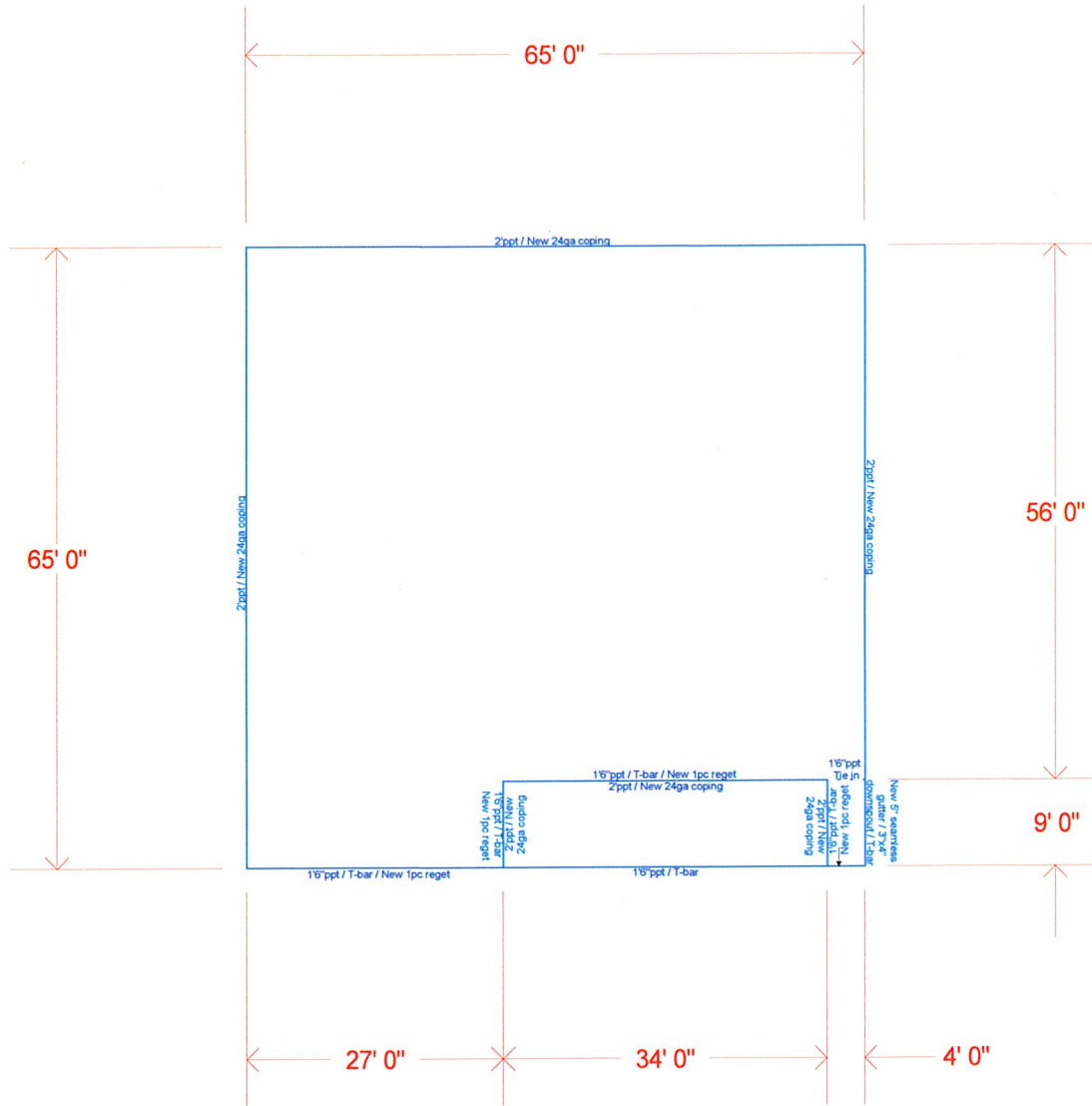

Roofing excellence since 1979.



3830 NW 16th St.  
 TOPEKA, KS 66618  
 PHONE 785-232-4276  
 FAX 785-232-2856

Scale:	NOT to scale	Date:	04/07/2022
Drawing Title:	Carbondale Attendance Center - Carbondale, KS		
Drawn By:	Steve Kauffman	Drawing No.:	1