

REMOVE EXISTING WINDOW ASSEMBLY AND MASONRY, PREPARE FOR NEW RATED DOOR & GLAZING ASSEMBLIES, AREAS LIMITED PER NFPA 80

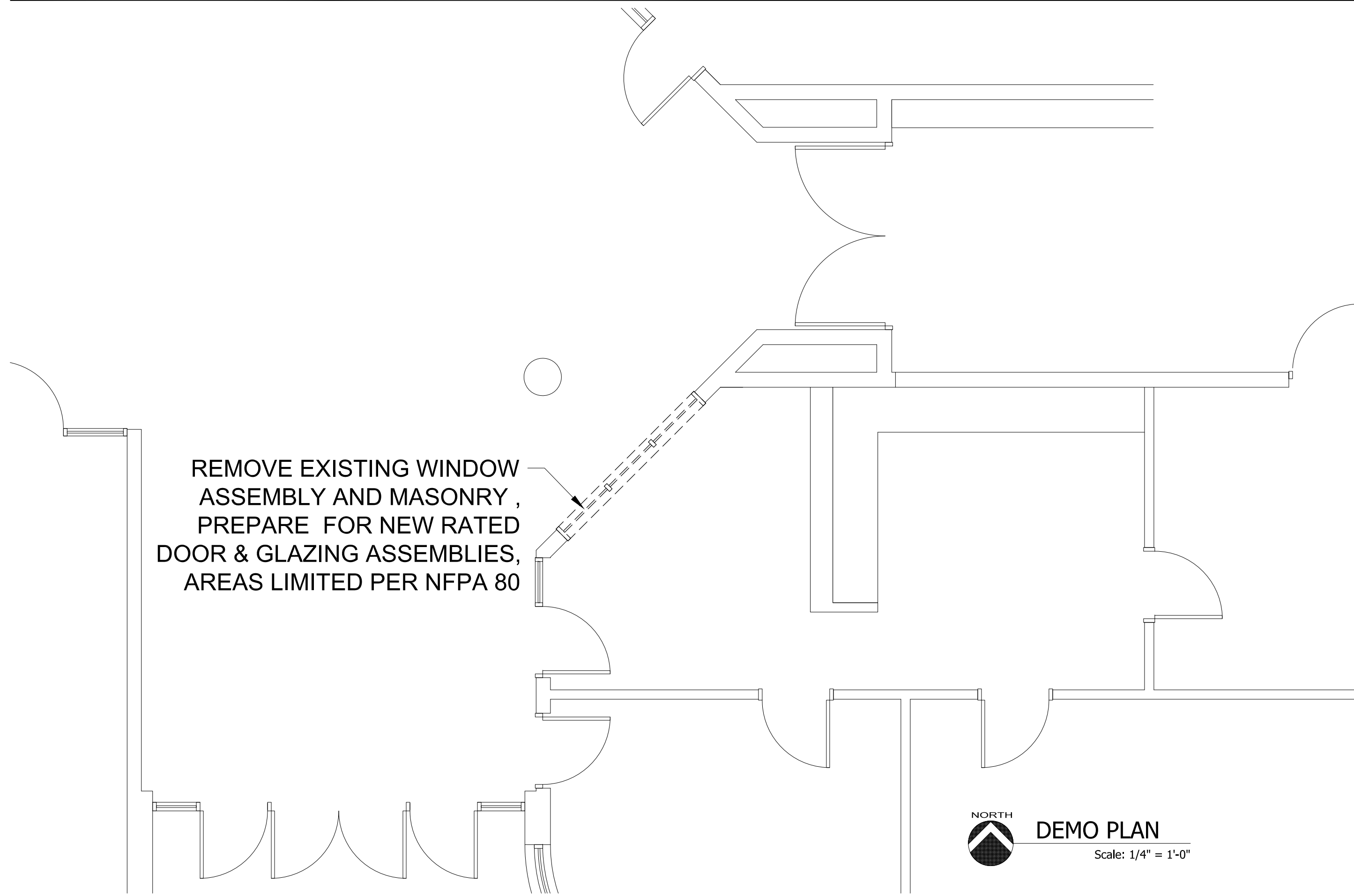

DEMO PLAN

Scale: 1/4" = 1'-0"

DATE: 27 SEPTEMBER 2018
UNIFIED SCHOOL DISTRICT 434

PRELIMINARY
NOT FOR CONSTRUCTION

DEMO PLAN
A1.0

pearson
architecture studio
bobbi@pearson-studio.com
785 220 6898

OVERBROOK ATTENDANCE CENTER
202 WEST 7TH STREET
OVERBROOK, KANSAS 66524

NEW 20 MINUTE RATED DOOR
& GLAZING ASSEMBLIES WITH
AREAS LIMITED PER NFPA 80,
1 HOUR WALL CONSTRUCTION

ONE-WAY, RELEASE CONTROLLED ACCESS

NEW NON-RATED
PARTITION WITH DOORS
& GLAZING ASSEMBLY
SIMILAR TO EXTERIOR
ASSEMBLY



FLOOR PLAN

Scale: 1/4" = 1'-0"

DATE: 27 SEPTEMBER 2018
UNIFIED SCHOOL DISTRICT 434

OVERBROOK ATTENDANCE CENTER
202 WEST 7TH STREET
OVERBROOK, KANSAS 66524

pearson
architecture studio

bobbi@pearson-studio.com
785 220 6898

PRELIMINARY
NOT FOR CONSTRUCTION

COMPOSITE PLAN

A1.1